

RE-428DU-S

SINGLE TUBE ADDRESSABLE DUCT DETECTOR

General

This addressable smoke detector can be installed on any side of the duct. The detector RE-428DU-S contains an intelligent controlling circuit. The circuit adjusts the sensitivity to give an optimal function throughout the entire life of the detector. Advanced Venturi tube technology with single tube detector. This duct detector housed with the flow optimization and three different length level pipes available.

Features

- High efficient single sampling tube.
- Easy to install.
- One-pipe air sampling system.
- Patented venturi pipe and duct housing.
- Test hole on cover.
- Simple installation.
- Simple service and maintenance.



Specification

	Electrical Specification
<i>Operating Voltage</i>	17 ~ 28 VDC
<i>Operating Temperature</i>	-10 – 37.8° C
<i>Storage Temperature</i>	-10 – 60° C
<i>Humidity</i>	0 - 95% RH, non-condensing
<i>Reset Voltage</i>	Less than 3V
<i>Standby Current</i>	500 µA
<i>Alarm Current</i>	5 mA
<i>Startup Time</i>	30sec
<i>Remote Output</i>	2mA maximum open collector
<i>Smoke Sensitivity</i>	(2.12 ± 0.61) % obs/ ft. (High: 1.1; Medium: 1.4; Low: 2.3)% obs/ft
<i>Air Velocity</i>	0 – 4000 fpm
<i>Dimensions</i>	(241 L X 195 W X 68 D) mm
<i>Weight</i>	1.04 kg
<i>Air Sampling Tube</i>	Aluminium (Hole Diameter 1.5" (38 mm))

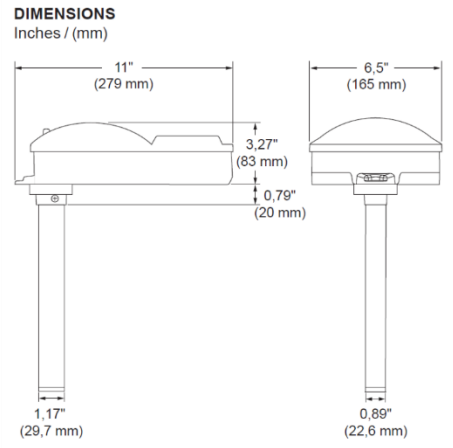
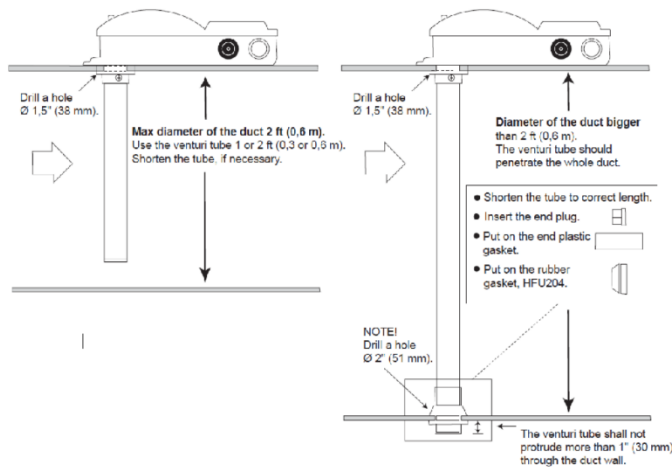

Compatible Panel

Model	Description
<i>Avani</i>	Analogue addressable Fire Alarm Control panel expandable upto 4 loop
<i>Avani db</i>	Analogue Addressable Fire Alarm Control panel expandable upto 2 loop
<i>Avani XL</i>	Analogue Addressable Fire Alarm Control panel expandable upto 8 Loop

Ordering Information

Model	Description
RE-428DU-S	Single tube Addressable Duct Detector
RE-428DU-S2	Sampling tube length: 2 ft (0.6 m)

India

RAVEL ELECTRONICS PVT LTD.,
150A, Electronics Industrial Estate,
Perungudi, Chennai – 96, India.
E-mail: marketing@ravelfire.com; Web: www.ravelfire.com

United Kingdom

RAVEL ELECTRONICS LTD.,
Unit 11, Chancel Industrial Estate, Newhall street,
Willenhall WV13 1NX, West Midlands, United Kingdom.
E-mail: info@ravelfire.co.uk; Web: www.ravelfire.co.uk

USA

RAVEL AMERICAS INC.,
2855 NW 112th Ave ST#2 Miami,
Doral, Florida 33172, USA.